

Soils Map - Total Acres per Whiteside Co., FSA

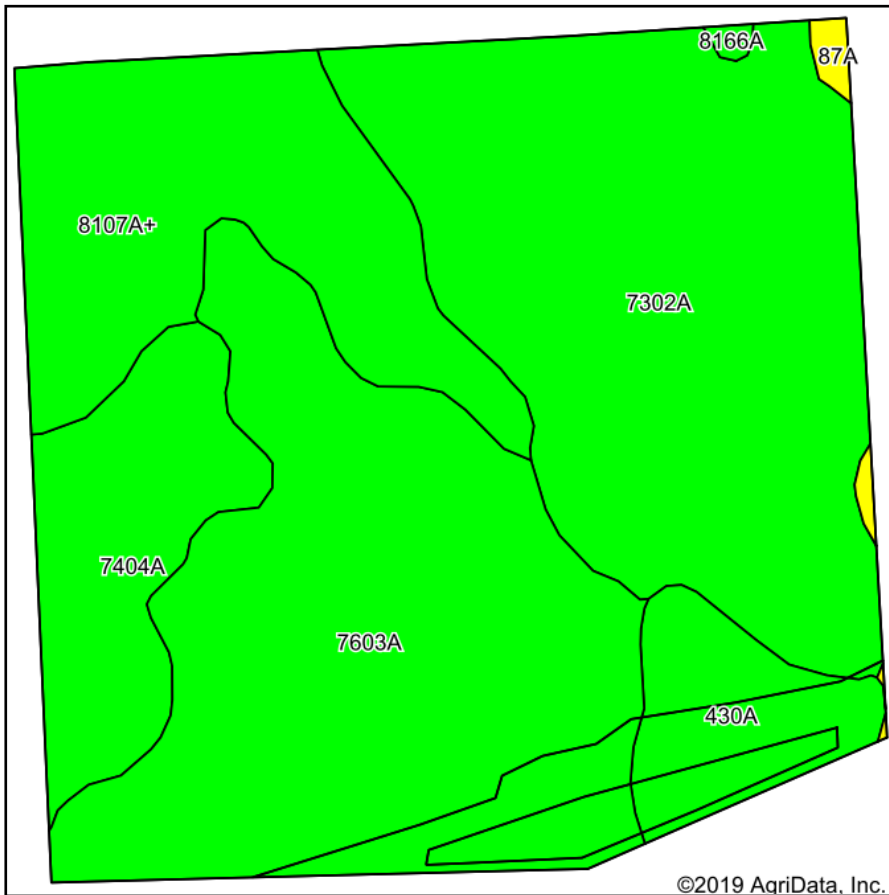

Soils data provided by USDA and NRCS.

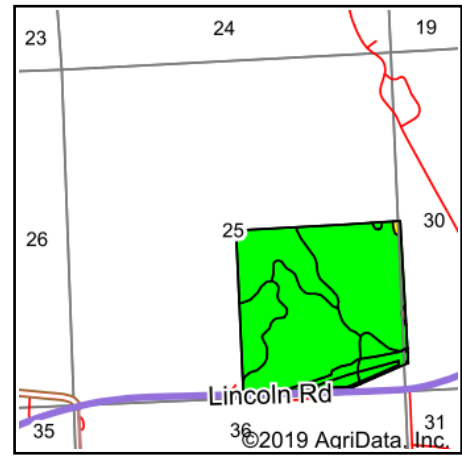

State: **Illinois**
 County: **Whiteside**
 Location: **25-22N-3E**
 Township: **Fulton**
 Acres: **146.82**
 Date: **7/12/2019**



Maps Provided By:



© AgriData, Inc. 2019

www.AgriDataInc.com



Area Symbol: IL195. Soil Area Version: 15										
Code	Soil Description	Acres	Percent of field	Il. State Productivity Index Legend	Corn Bu/A	Soybeans Bu/A	Wheat Bu/A	Oats Bu/A ^b	Alfalfa ^d hay, T/A	Crop productivity index for optimum management
7302A	Ambraw clay loam, 0 to 2 percent slopes, rarely flooded	50.33	34.3%		154	50	61	75	0.00	114
7603A	Blackoar silt loam, 0 to 2 percent slopes, rarely flooded	48.72	33.2%		178	57	66	88	0.00	131
8107A+	Sawmill silt loam, 0 to 2 percent slopes, occasionally flooded, overwash	24.36	16.6%		189	60	71	98	0.00	139
7404A	Titus silty clay loam, 0 to 2 percent slopes, rarely flooded	14.05	9.6%		158	52	61	75	0.00	118
430A	Raddle silt loam, 0 to 2 percent slopes	8.24	5.6%		189	59	73	97	6.52	138
87A	Dickinson sandy loam, 0 to 2 percent slopes	0.84	0.6%		142	46	56	74	3.39	104
8166A	Cohoctah loam, 0 to 2 percent slopes, occasionally flooded	0.28	0.2%		177	60	74	93	0.00	133
Weighted Average					170.1	54.7	65	84.4	0.39	125.5

Table: Optimum Crop Productivity Ratings for Illinois Soil by K.R. Olson and J.M. Lang, Office of Research, ACES, University of Illinois at Champaign-Urbana. Version: 1/2/2012 Amended Table S2 B811

Crop yields and productivity indices for optimum management (B811) are maintained at the following NRES web site: <http://soilproductivity.nres.illinois.edu/>

** Indexes adjusted for slope and erosion according to Bulletin 811 Table S3

^b Soils in the southern region were not rated for oats and are shown with a zero "0".

^d Soils in the poorly drained group were not rated for alfalfa and are shown with a zero "0".

*c: Using Capabilities Class Dominant Condition Aggregation Method

Soils data provided by USDA and NRCS. Soils data provided by University of Illinois at Champaign-Urbana.